

TITLE: SPECIFICATION CONTROL DRAWING

PART IDENTIFIER: 5307ALN

DESCRIPTION: HIGH POWER LOAD, ALUMINUM NITRIDE, (THICK FILM)

ASSEMBLY DWG: 1700374

1.0 SPECIFICATIONS:

- 1.1 ELECTRICAL:
 - 1.1.1 RESISTANCE VALUE: 50Ω NOMINAL.
 - 1.1.2 INPUT POWER: 125 WATTS AT 100°C HEAT SINK, DERATED LINEARLY TO ZERO WATTS AT 150°C.
 - 1.1.3 FREQUENCY RANGE: DC - 2.0 GHZ.
 - 1.1.4 VSWR: 1.25 MAX.

- 1.2 MECHANICAL:
 - 1.2.1 OUTLINE DWG: SEE SHEET 2.
 - 1.2.2 WORKMANSHIP: PER MIL-PRF-55342.

- 1.3 ENVIRONMENTAL:
 - 1.3.1 TEMPERATURE RANGE:
 - 1.3.1.1 STORAGE: -65°C TO +150°C.
 - 1.3.2.1 OPERATING: -55°C TO +150°C.

2.0 UNIT MARKING: "EMCT" AND PART IDENTIFIER.
LEGIBILITY AND PERMANENCY PER MIL-STD-130.

3.0 QUALITY ASSURANCE:

- 3.1 VISUAL AND MECHANICAL PER 824W155.
- 3.2 100% DC RESISTANCE CHECK (GO/NO GO): 50Ω ± 5%.
- 3.3 DATA REQUIREMENTS:
 - 3.3.1 NO TEST DATA REQUIRED FOR CUSTOMER.
 - 3.3.2 DATA RETENTION – 24 MONTHS.

4.0 PACKAGING: STANDARD PACKING PER 755W002.

EMC TECHNOLOGY 8851 SW OLD KANSAS AVE. STUART, FL 34997	CAGE CODE # 24602		DWG #	1008435000
	CHANGE NOTICE	EN 08-E0341	REV LVL	J
			SHEET	1 <u>OF</u> 2

PART ID REF

5307ALN

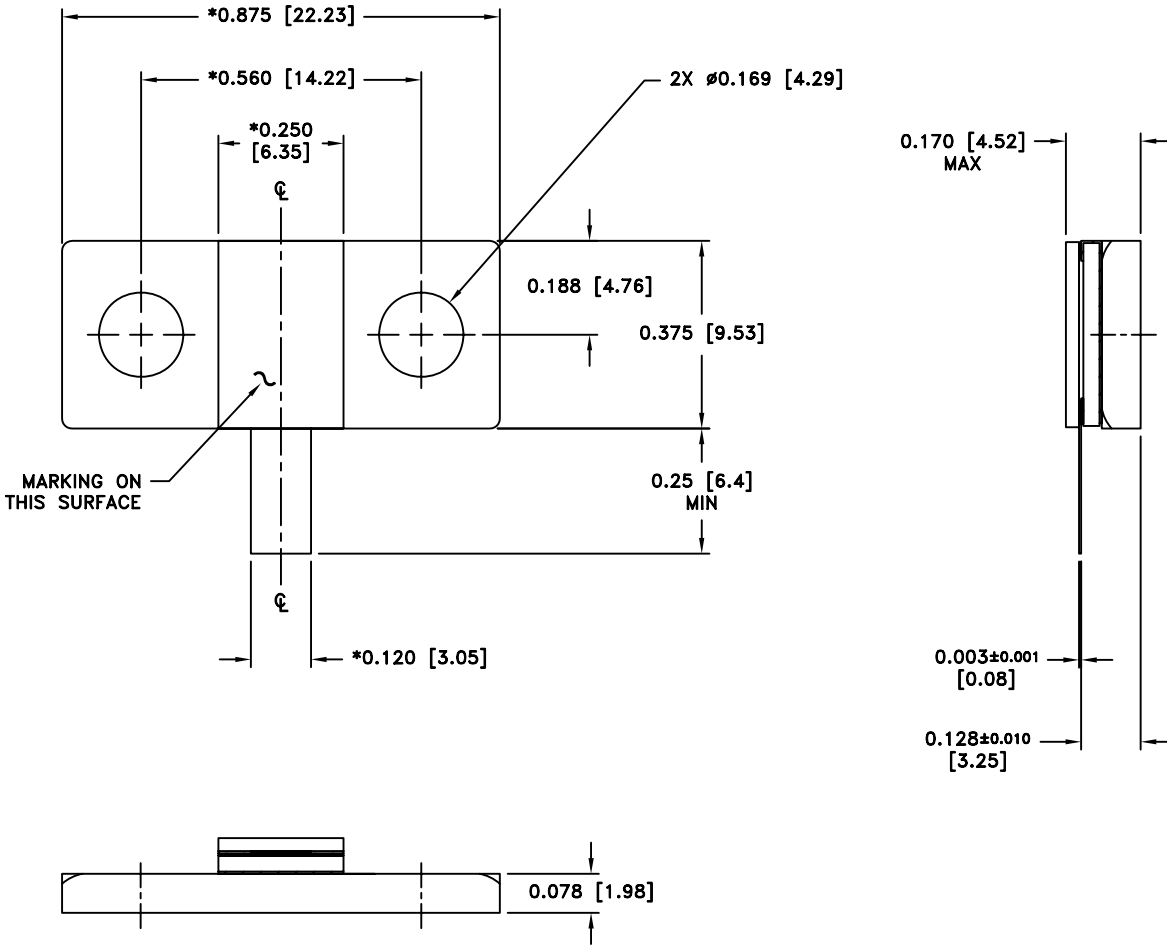

MECHANICAL SPECIFICATIONS:

- CHIP:
 - MATERIAL - SUBSTRATE - ALUMINUM NITRIDE, MIL-I-10.
 - RESISTIVE ELEMENT - THICK FILM.
- TOP PLATE:
 - MATERIAL - ALUMINA, MIL-I-10.
- TAB:
 - MATERIAL - COPPER, ASTM B152.
 - FINISH - SILVER, QQ-S-365.
- HEAT SINK:
 - MATERIAL - COPPER, ASTM B187.
 - FINISH - NICKEL, QQ-N-290.

METRIC EQUIVALENTS GIVEN IN [mm] FOR REFERENCE INFORMATION ONLY

ALLOW ± 0.010 ON TOP PLATE FOR MISALIGNMENT.
 *DIMENSIONS TO BE SYMMETRICAL ABOUT C.L. WITHIN ± 0.005 .

POWER RATING AND DERATING

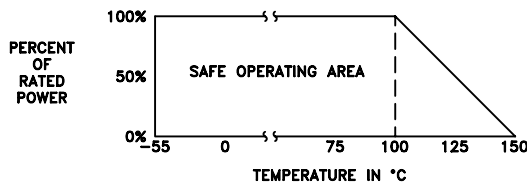

8851 SW OLD KANSAS AVE
 STUART, FL 34997
 PHONE NO. (772)286-9300
 FAX NO. (772)283-5286

UNLESS OTHERWISE SPECIFIED DIMENSIONS ARE IN INCHES

TOLERANCES

FRACT	---
ANG	---
XX	---
XXX	± 0.005
XXXX	---

THESE DRAWINGS AND SPECIFICATIONS ARE THE PROPERTY OF EMC TECHNOLOGY INC AND SHALL NOT BE DUPLICATED OR USED AS BASIS FOR THE MANUFACTURE OR SALE OF PARTS OR DEVICES WITHOUT PERMISSION.

CAGE CODE	SCALE	DRAWN BY	CHECKED BY	APPROVED BY
24602	4:1	JG 5/1/08		
REV	CHANGE NOTICE	DRAWING NO	SHEET	
J	EN 08-E0341	1008435000	2 OF 2	