

TITLE: SPECIFICATION CONTROL DRAWING

PART IDENTIFIER: 5307ALN

DESCRIPTION: HIGH POWER LOAD, ALUMINUM NITRIDE, (THICK FILM)

ASSEMBLY DWG: 1700374

1.0 SPECIFICATIONS:

1.1 ELECTRICAL:

- 1.1.1 RESISTANCE VALUE: 50Ω NOMINAL.
- 1.1.2 INPUT POWER: 125 WATTS AT 100°C HEAT SINK, DERATED LINEARLY TO ZERO WATTS AT 150°C.
- 1.1.3 FREQUENCY RANGE: DC - 2.0 GHZ.
- 1.1.4 VSWR: 1.25 MAX.

1.2 MECHANICAL:

- 1.2.1 OUTLINE DWG: SEE SHEET 2.
- 1.2.2 WORKMANSHIP: PER MIL-PRF-55342.

1.3 ENVIRONMENTAL:

- 1.3.1 TEMPERATURE RANGE:
 - 1.3.1.1 STORAGE: -65°C TO +150°C.
 - 1.3.2.1 OPERATING: -55°C TO +150°C.

2.0 UNIT MARKING: "EMCT" AND PART IDENTIFIER.
LEGIBILITY AND PERMANENCY PER MIL-STD-130.

3.0 QUALITY ASSURANCE:

- 3.1 VISUAL AND MECHANICAL PER IP-1022.
- 3.2 100% DC RESISTANCE CHECK (GO/NO GO): 50Ω ± 5%.
- 3.3 DATA REQUIREMENTS:
 - 3.3.1 NO TEST DATA REQUIRED FOR CUSTOMER.
 - 3.3.2 DATA RETENTION – 24 MONTHS.

4.0 PACKAGING: STANDARD PACKING PER MC0023.

| | | | | | | | | | |
|------------------------|--|-------------------|-----------|-----|--|---------|---------------|----|--|
| ENG | | PUR | | MFG | | PLAN | | SM | |
| CC | | | | QA | | | | | |
| EMC TECHNOLOGY, INC | | CAGE CODE # 24602 | | | | DWG # | 1008435000 | | |
| 1971 OLD CUTHBERT ROAD | | CHANGE NOTICE | EN 02-202 | | | REV LVL | H | | |
| CHERRY HILL, NJ 08034 | | | | | | SHEET | 1 <u>OF</u> 2 | | |

PART ID REF

5307ALN

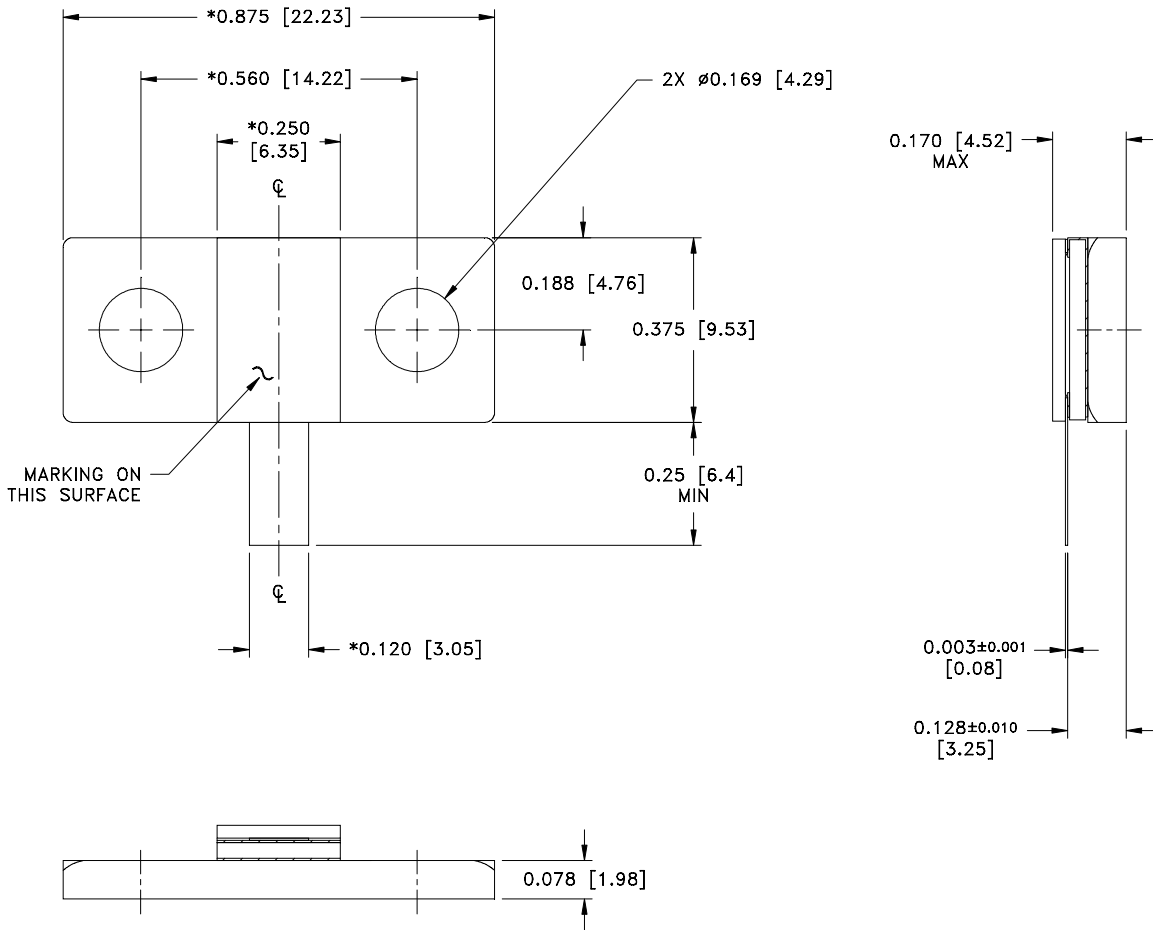

MECHANICAL SPECIFICATIONS:

- CHIP:
 - MATERIAL - SUBSTRATE - ALUMINUM NITRIDE, MIL-I-10.
 - RESISTIVE ELEMENT - THICK FILM.
- TOP PLATE:
 - MATERIAL - ALUMINA, MIL-I-10.
- TAB:
 - MATERIAL - COPPER, ASTM B152.
 - FINISH - SILVER, QQ-S-365.
- HEAT SINK:
 - MATERIAL - COPPER, ASTM B187.
 - FINISH - NICKEL, QQ-N-290.



METRIC EQUIVALENTS GIVEN IN [mm] FOR REFERENCE INFORMATION ONLY

ALLOW ± 0.010 ON TOP PLATE FOR MISALIGNMENT.
 *DIMENSIONS TO BE SYMMETRICAL ABOUT C.L. WITHIN ± 0.005 .

POWER RATING AND DERATING

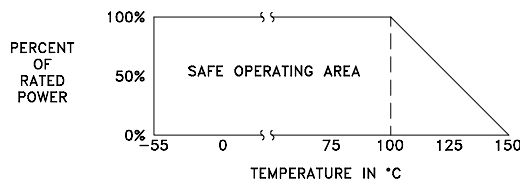

1971 OLD CUTHBERT RD
 CHERRY HILL NJ 08034
 PHONE NO. (856) 429-7800
 FAX NO. (856) 429-1807

UNLESS OTHERWISE SPECIFIED DIMENSIONS ARE IN INCHES TOLERANCES
 FRACT --- --
 ANG --- --
 XX --- --
 XXX ± 0.005
 XXXX --- --

THESE DRAWINGS AND SPECIFICATIONS ARE THE PROPERTY OF EMC TECHNOLOGY INC AND SHALL NOT BE DUPLICATED OR USED AS BASIS FOR THE MANUFACTURE OR SALE OF PARTS OR DEVICES WITHOUT PERMISSION.

| | | | | |
|--------------------|----------------------------|--------------------------|-----------------|---------------------------|
| CAGE CODE 24602 | SCALE 4:1 | DRAWN BY CSS 6-3-02 | CHECKED BY | APPROVED BY DAR 6/4/02 |
| REV H | CHANGE NOTICE EN 02-202 | DRAWING NO 1008435000 | SHEET 2 OF 2 | |